

FEATURES



FLANGELESS

DESIGN:

Two-Piece Construction (reflector and a mud ring)

REFLECTOR

FINISHES:

- Painted
 - Black
 - White
 - Custom Colors (by special order)

MATERIAL:

Die-cast Aluminum

MUD RING

Cast Aluminum

FINISH: Painted White

COMPATIBILITY

RECESSED DOWNLIGHTS:

- RL4V and RL4VR Series

WARRANTY

5-YEAR LIMITED WARRANTY



Catalog #:

Type:

Project:

Prepared By:

AT A GLANCE

Beveled splay style downlight trim series for the RL4, 4" diameter recessed downlights. Made from die-cast aluminum, the trims can be painted or anodized to meet the needs of the most difficult of applications. The trims are configured for flangeless installations.

ORDER CONFIGURATOR

To order, select one option from each table column to configure the desired wall wash trim product catalog code. Then, fill in the boxes below (Example: Flangeless Trim #: 6023-R-WH-NF). To order recessed downlights, use the corresponding specification sheet for the compatible RL3V or RL3VR recessed downlight series.

WALL WASH TRIM

6023	R		NF
WALL WASH TRIM MODEL	SHAPE	REFLECTOR FINISH	FLANGE
<input checked="" type="checkbox"/> 6023	<input checked="" type="checkbox"/> R Round	<input type="checkbox"/> BK Black (Painted) <input type="checkbox"/> WH White (Painted) <input type="checkbox"/> CST Custom	<input checked="" type="checkbox"/> NF No Flange (i.e. aka "FL" flangeless)

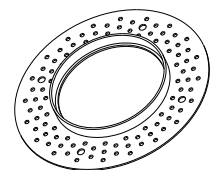
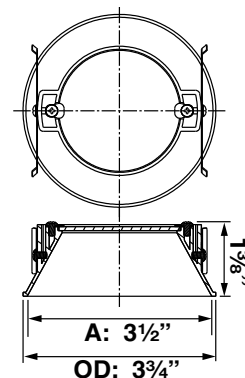

Mud ring included.